

Spring Lake Park High School Phase I: first of multiple construction projects to recreate a “new” school: new drawings of fine arts and athletic addition



Architect's conception of new athletic/fine arts addition to the high school. East or Highway 65 view.

Some highlights:

Following at least three significant construction phases during the next few years, Spring Lake Park High School will be an essentially “new” school. Highlights of phase I construction, to begin shortly, are below:

- New band room, choir room, multi-purpose/jazz band room, support spaces for music
- New main entrance to the school building will be on the east or Highway 65 side
- Visitors bleachers for Panther Stadium will be moved forward
- Blue Gym will become the new “game or performance gym” venue with 1,500 seats or a 50% increase in seating capacity
- New multi-purpose/wrestling room
- New multi-teaching-station, 3-court basketball, 4-court volleyball gymnasium
- New weight room
- New fitness room
- New men’s and women’s athletic lockers
- New men’s and women’s Phy. Ed. lockers
- Capacity to host Commencement on campus; inside during inclement weather
- Demolition of the current “Early Childhood” wing (future fine arts/athletic addition) will begin in March, construction will begin in April, the newly renovated Blue Gym should be ready for fall practices, and in December the entire fine arts/athletic addition would be completed.
- The goal is to have Phase I totally completed by December 2007.
- Phase I construction costs: approximately \$11 million

Spring Lake Park High School, Phase I

Fine arts/athletic addtion



*Architect's conception of new athletic/fine arts addition to the high school.
From top to bottom: southeast view, southwest view, west view*

Spring Lake Park High School, Phase I

Fine arts/athletic addtion

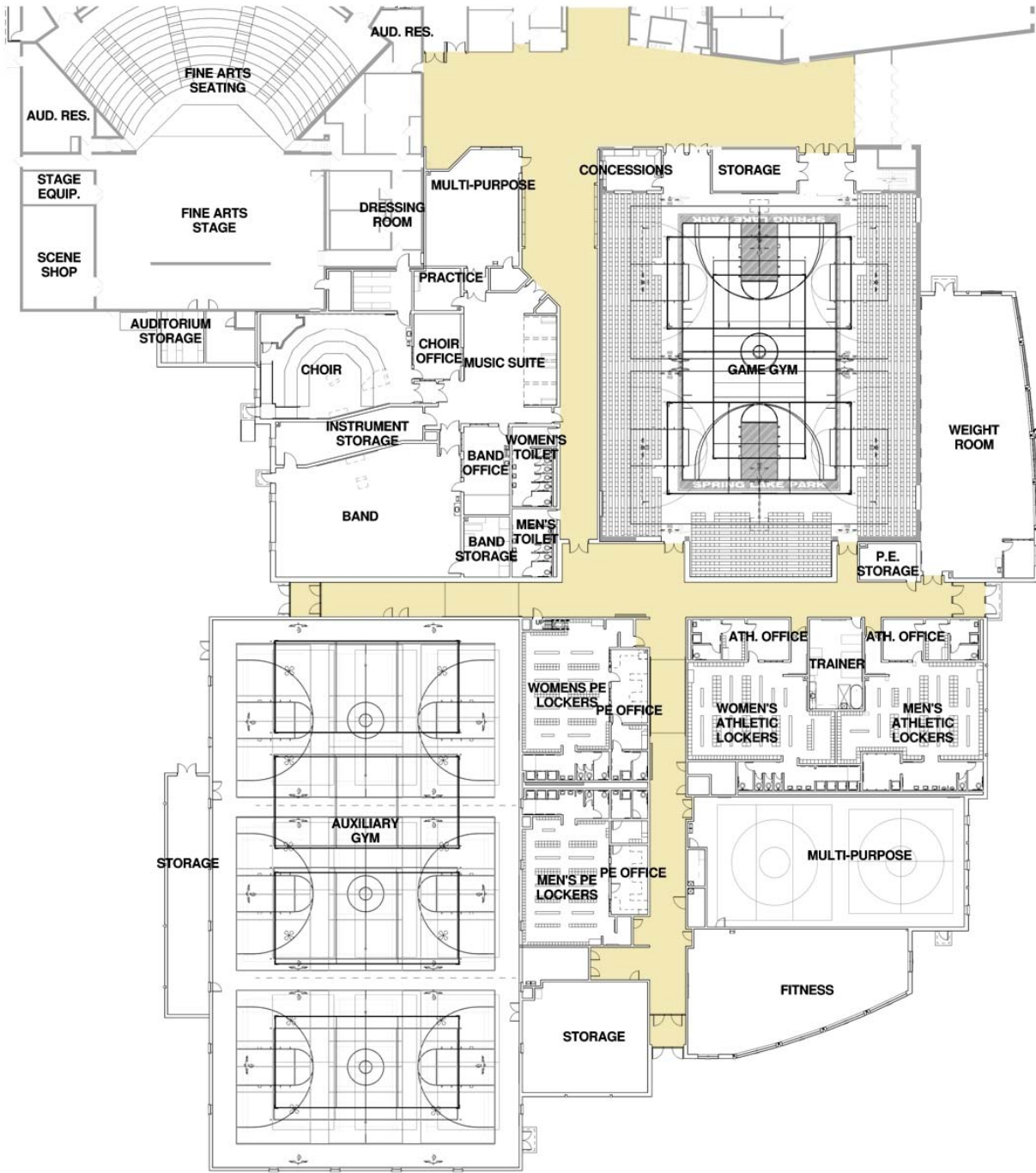

PHASE 1 - MAIN FLOOR PLAN
1/16" = 1'-0"