

March 11, 2007

New architect's drawings for Spring Lake Park High School phase I construction projects for summer 2007



Architect's conception of new athletic/fine arts addition to the high school. East view.

At the Spring Lake Park High School complex site, demolition of the current "Early Childhood Programs" wing will begin in March once the asbestos abatement project is completed. *(The district's Early Childhood programs will temporarily move to the new District Services Center in March.)*

In April, construction will begin to substantially renovate and expand the high school Blue Gym, as well as to construct an auxiliary gym which will feature three full-size basketball courts and/or four volleyball courts.

A new band and choir area will also be constructed, as will a new fitness center and weight room area.

The newly renovated gym should be available by the time fall practices begin and by Christmas break, the entire new athletic and fine arts addition will be completed.

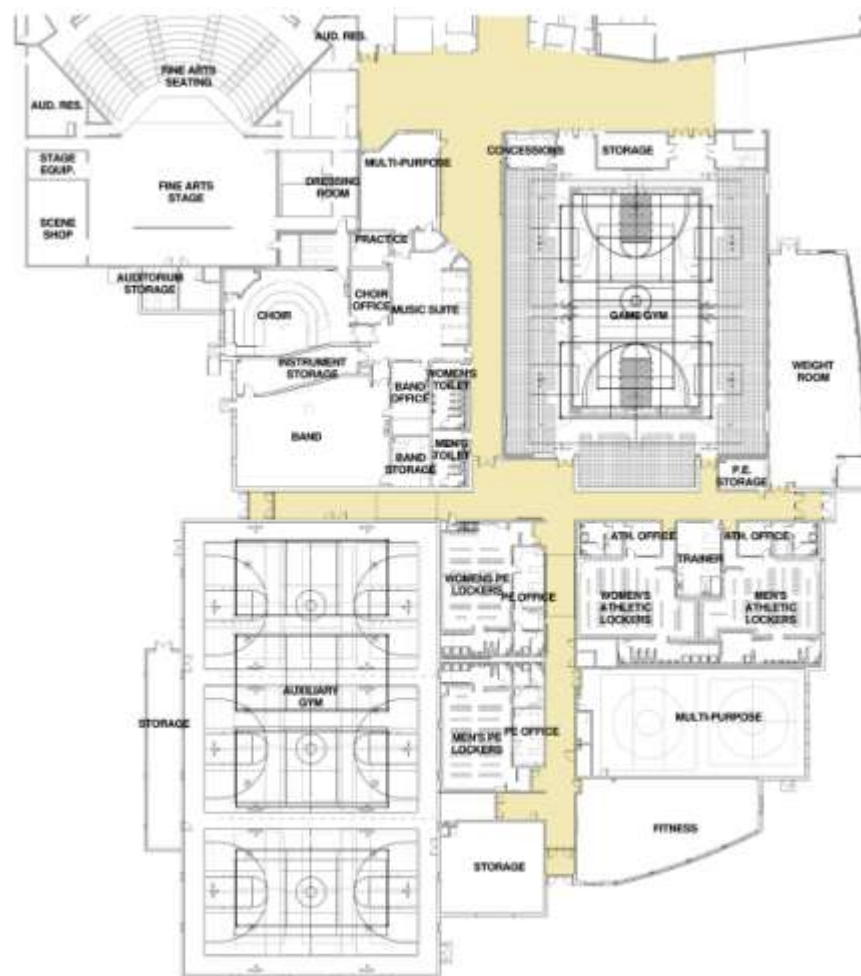



*Architect's conception of new athletic/fine arts addition to the high school.
From top to bottom: southeast view, southwest view, west view*